

HVE01 - Seismic

Heavy Duty Fixing System

High performance steel anchor with 8.8 grade Hex Head screw and special hardened washer with patented design, zinc plated, ETA-CE Opt.1 certified.

Applications:

- Steel construction
- Heavy HVAC
- Concrete propping
- Infrastructure & civil engineering e.g. bridges
- Airports and transport infrastructure
- Heavy duty machinery
- Data centres and high risk applications

Advantages:

- ETA Option 1 for cracked and non-cracked concrete
- C1 and C2 seismic certified
- Fire rated R120
- Sleeved through bolt anchor for very high shear loads
- Internal cone expansion - no anchor displacement when setting

Product Promise:

A very highly certified anchor for assurance and performance in high load and safety critical applications.



Application submitted for an ICC-ES evaluation report covering seismic action in accordance with ACI 355.2



European Technical Assessment
ETA-10/0060 - ETAG 001 - PART 1 - 2 - ANNEX E

OPTION 1: cracked and non-cracked concrete.

Seismic assessment - performance category C2 - C1.



Item included in TADS - Tecfi Anchor Design Software for computer aided design of Anchorage.

THE NEW STANDARD
IN NEW ZEALAND
CONCRETE FIXING

HVE01 - Seismic Heavy Duty Fixing System

HVE01 sizes:

Item Code	Anchor size Ø x La / t fix (mm)	Screw size M	Pcs. per Box	Pcs. per Ctn
Ø 10 - M6 - AF 10				
HVE 01 10 070	10 x 70 / 5	M6	50	500
HVE 01 10 080	10 x 80 / 15	M6	50	500
HVE 01 10 100	10 x 100 / 35	M6	50	500
HVE 01 10 120	10 x 120 / 55	M6	50	500
Ø 12 - M8 - AF 13				
HVE 01 12 080	12 x 80 / 10	M8	50	250
HVE 01 12 100	12 x 100 / 30	M8	25	250
HVE 01 12 120	12 x 120 / 50	M8	25	250
HVE 01 12 140	12 x 140 / 70	M8	25	250
Ø 16 - M10 - AF 17				
HVE 01 16 100	16 x 100 / 5	M10	20	100
HVE 01 16 120	16 x 120 / 15	M10	20	100
HVE 01 16 140	16 x 140 / 35	M10	20	100
HVE 01 16 160	16 x 150 / 55	M10	20	100
Ø 18 - M12 - AF 19				
HVE 01 18 120	18 x 120 / 20	M12	10	100
HVE 01 18 150	18 x 150 / 50	M12	10	50
HVE 01 18 170	18 x 170 / 70	M12	10	50
HVE 01 18 200	18 x 200 / 100	M12	10	50
Ø 24 - M16 - AF 24				
HVE 01 24 140	24 x 140 / 20	M16	5	25
HVE 01 24 170	24 x 170 / 50	M16	5	25
HVE 01 24 200	24 x 200 / 80	M16	5	25
HVE 01 24 220	24 x 220 / 100	M16	5	25

Installation procedure:

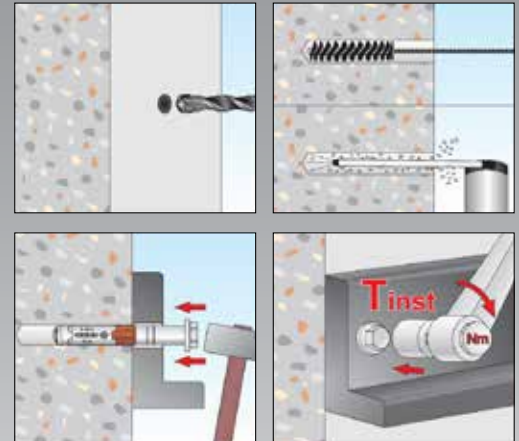

Our Range:

HVE01

HVE01 High performance steel anchor with 8.8 grade Hex Head screw and special hardness washer with patented design, zinc plated, ETA-CE Opt.1 certified.



HVE02

Hex nut and special washer.



HVE03

Flat CSK head Hex recess screw.



HVE04

Mushroom Head torx (anti-theft with small cap to be hammered).



Size Range: M6 to 16mm diameter and 70 to 220mm length.

THE NEW STANDARD
IN NEW ZEALAND
CONCRETE FIXING